

DO NOT SCALE
IF IN DOUBT ASK

163.6

MOUNTING FACE

5

207



CIR50 CALIPER PROFILE: DISC Ø362.5x32

1- TO MAKE A CALIPER PROFILE TEMPLATE TO CHECK CLEARANCE ON THE INSTALLATION, PRINT THIS DRAWING AT FULL SCALE, CHECK REF DIMENSIONS ARE CORRECT, GLUE IT TO CARDBOARD, AND CUT ALONG THE DOTTED LINE.

2- THE THINNER DASHED LINE REPRESENTS THE PROFILE OF THE CALIPER WITH NO CLEARANCE. THE THICKER LINE IS THE MAXIMUM PROFILE.

3- LOCATE THE TEMPLATE AROUND THE DISC LOCATION SPIGOT AND ROTATE THE TEMPLATE, CHECKING THAT THERE IS A MINIMUM OF 5mm CLEARANCE IN ALL POSITIONS.

4- IF IN DOUBT CONTACT ALCON TECHNICAL SALES DEPT

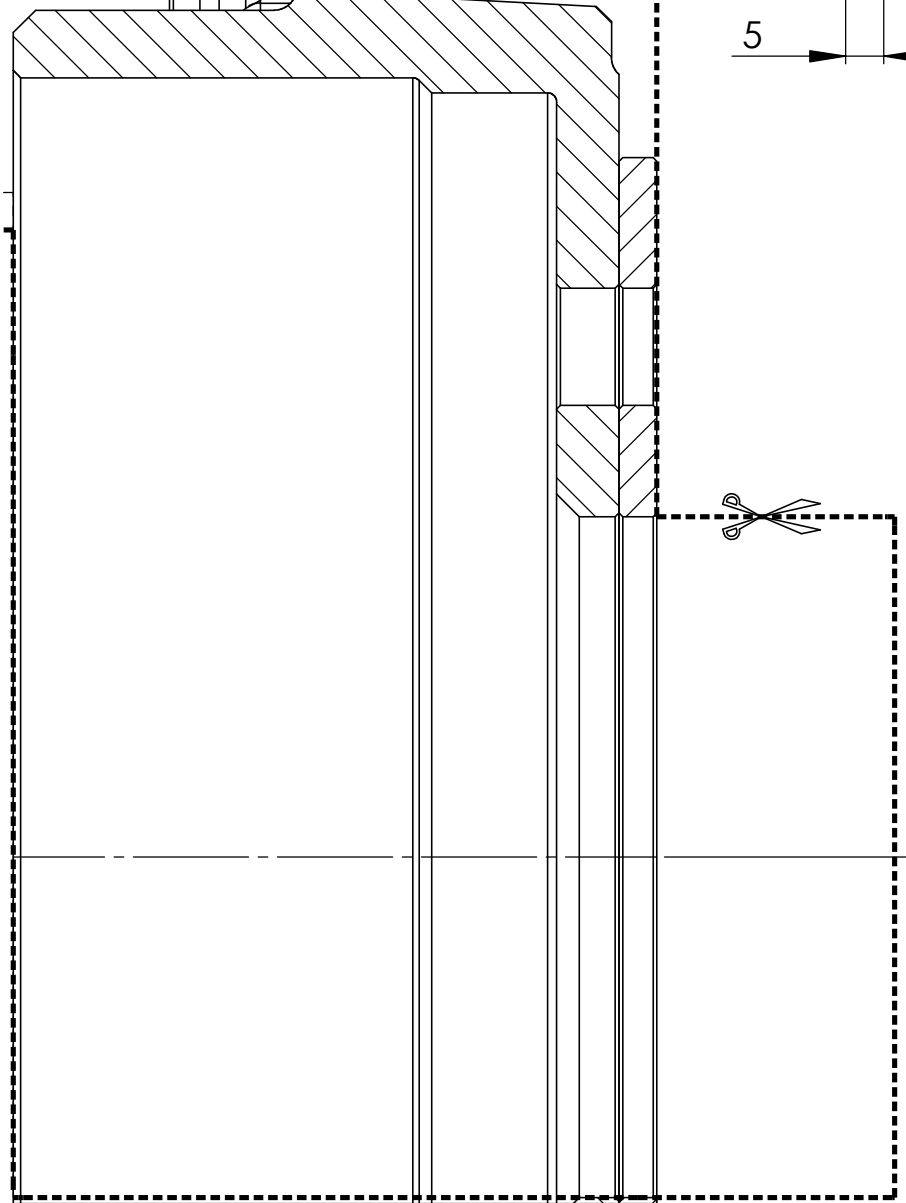

| | | | | |
|------------------------------------------------------------------------|------------------------------------------------------------|------------------------------------------------------------|-----------------------------------------------------------------------------------------------------------------|------------------------------------------------------------|
| DRAWN IN SOLIDWORKS <small>3D SOLIDWORKS</small> grams | Scale: 1:1 | Date: 24.08.17 | C.GOODYEAR ALCON COMPONENTS LIMITED ANFIELD TAMWORTH STAFFORDSHIRE B79 7TN TEL: +44(0)1827 73700 | |
| PROPERTY ALL RIGHTS RESERVED. BOUND AND SEALED ✓ Rg (Rg) | ALL DIMENSIONS ARE IN MILLIMETERS UNLESS STATED OTHERWISE. | ALL DIMENSIONS ARE IN MILLIMETERS UNLESS STATED OTHERWISE. | ALL DIMENSIONS ARE IN MILLIMETERS UNLESS STATED OTHERWISE. | ALL DIMENSIONS ARE IN MILLIMETERS UNLESS STATED OTHERWISE. |
| SURFACE FINISH: | SURFACE FINISH: | SURFACE FINISH: | SURFACE FINISH: | SURFACE FINISH: |
| CIRCULAR PROFILE - Ø362.5x32 (BKR5059D07) | | | Scale: 1 of 1 | Sheet: A4 |